

Owl key holder pouch

Instruction

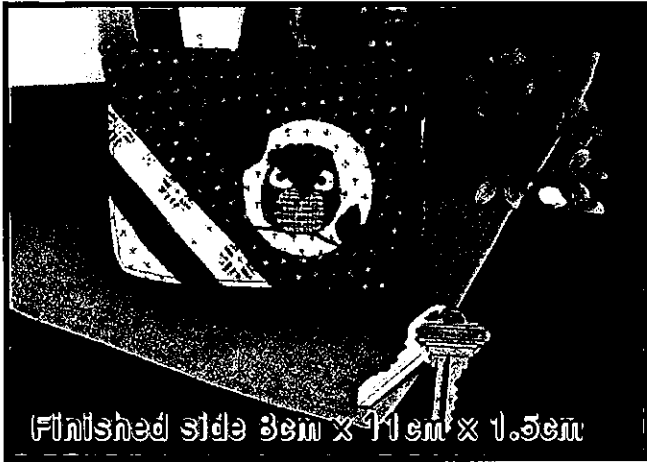

Finished side 3cm x 11cm x 1.5cm

Content

Top fabric (9 pcs), Lining (1 pce), Quilt batting (1 pce), Zipper (1 pce), Key ring (1 pcs), Snap button (1 set) Beads (2 pcs) Embroidery thread (1 pce) Making instruction, Full size template sheet

Things required

Sewing needle, Marking pin, Sewing thread (Similar color to fabric) Basting thread, Scissors, Ruler, Marking pen, Iron, Craft glue
 ※ Sewing machine is useful.

How to use full size template

- 1 Cut out all templates along with cutting line.
- 2 Refer to right layout, put templates on wrong side of fabric.
- 3 Mark cutting and finished line on fabric and cut fabric. (Mark cutting line on fabric first and cut template along finished line. Then mark finished line on fabric.)

Tips

- Use pins to avoid fabric being scooped, before stitching.
- Use one back stitch at beginning and ending.

www.olympus-thread.com

Read instruction fully before making.

Layout

- ※ Put templates with face up on wrong side of fabric. (Full size template are inverted so that you can put them on wrong side of fabric.)
- ※ Arrange all templates on fabric before cutting.

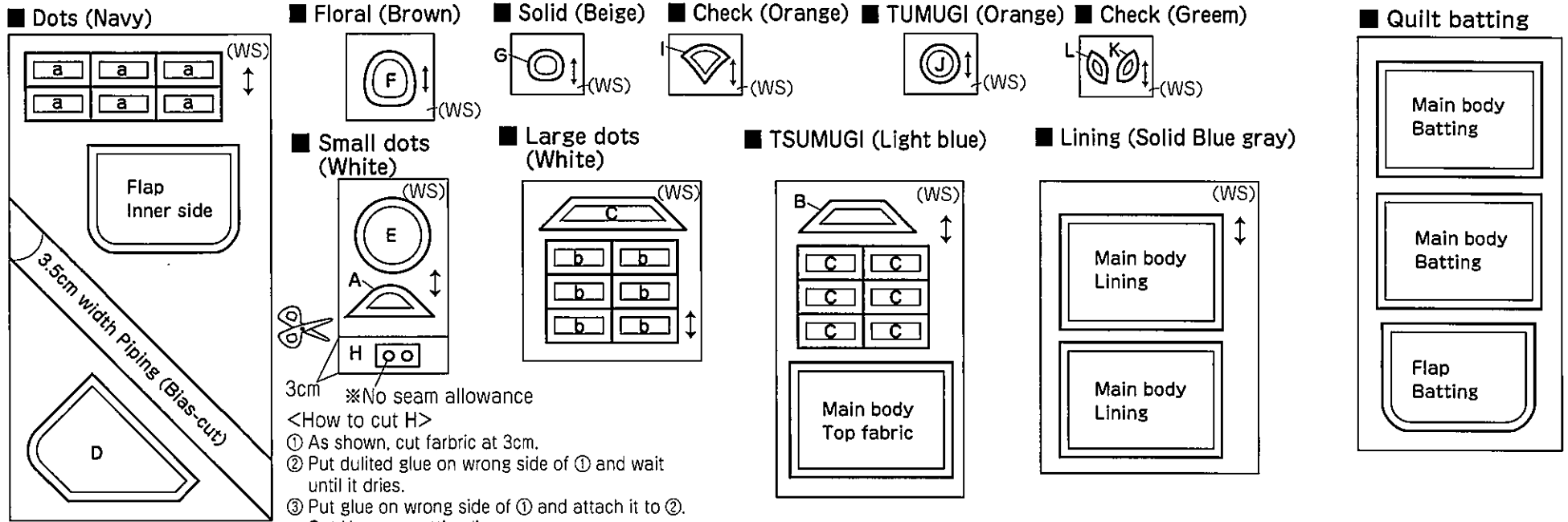
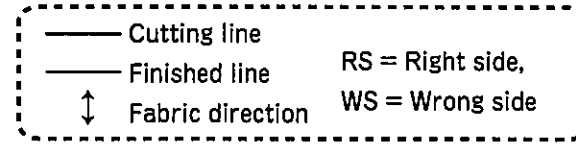

How to make

- 1 Cut fabric.
 ※Refer to "Layout" and "How to use full size template".
- 2 Make Flap Outer side.
 ※ Use pins to fix fabrics and stitch them together with tiny stitches.

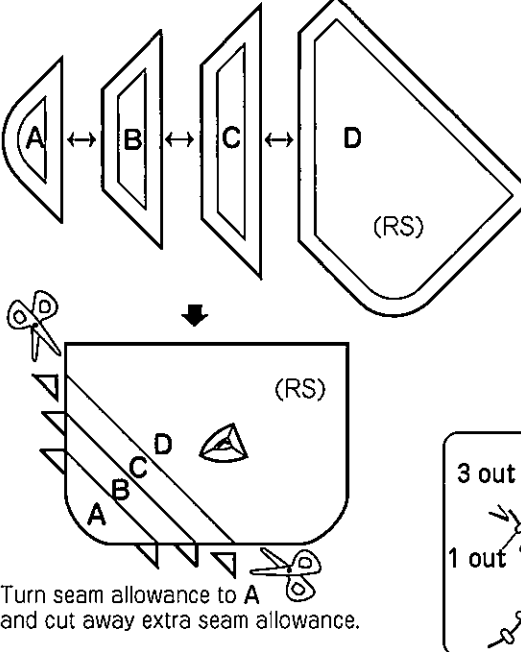

- 2 Applique F to L in order to Flap.
 ※Refer to full size finished image.
 ※ Cut H refer to how to cut H and glue H to F.

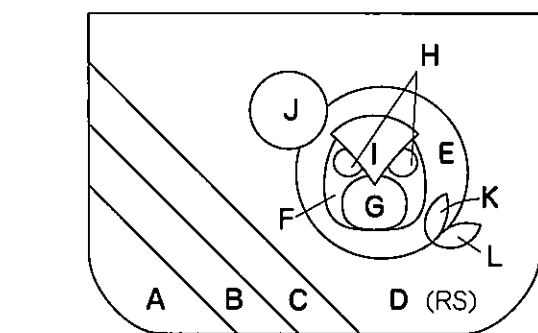

<How to applique>
 ※ Put cardboard template in it and arrange shape with iron except H.

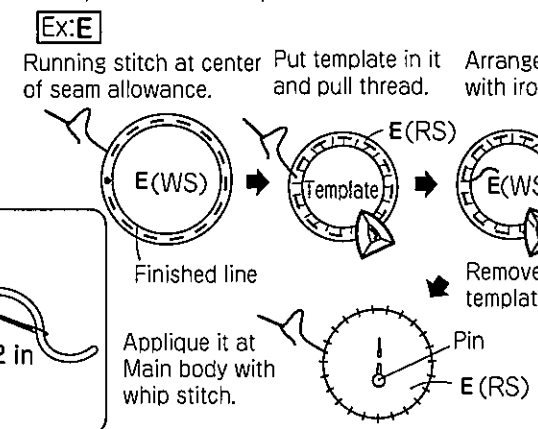

- 3 Stitch eye beads at H and stitch embroidery.

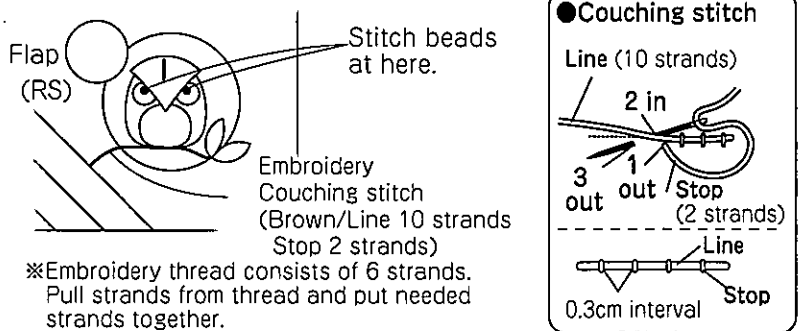

- 4 Put batting under Flap Outer side and stitch quilting.

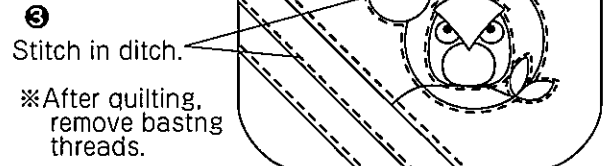
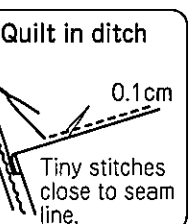
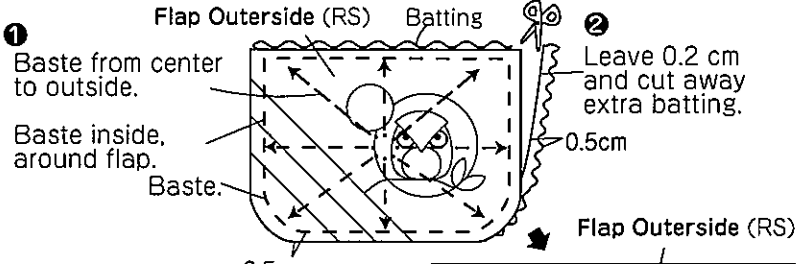

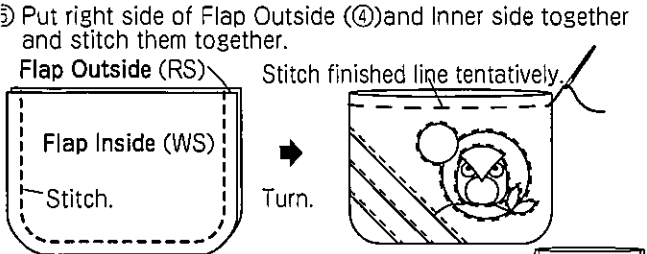

※In case of sewing machine, stitch inside around flap.

3 Make Main body Back.

① Put right side together, stitch a to c together. ※Turn seam allowance to c.

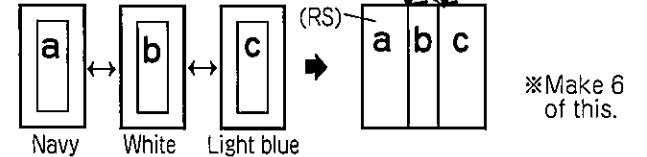

② Pay attention to piece direction, stitch them together.

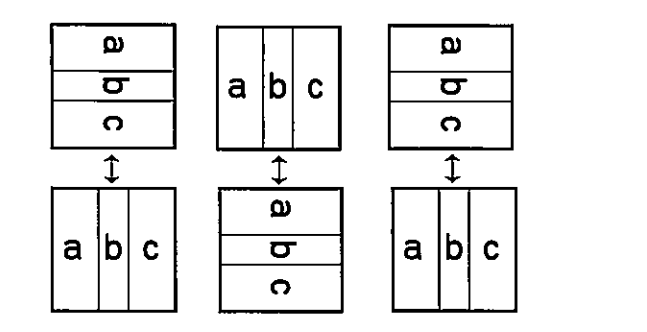

(RS) Turn seam allowance as shown.

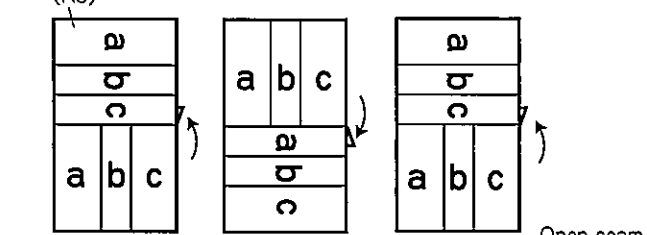

③ Stitch ② together and open seam.

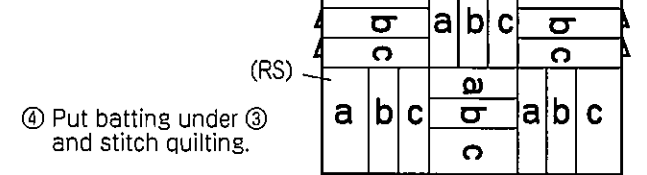

④ Put batting under ③ and stitch quilting.

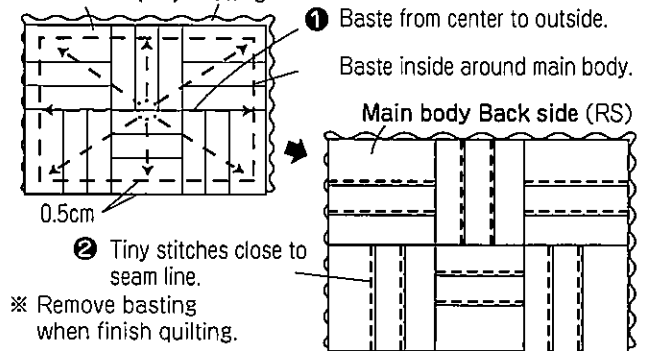

4 Make Main body Front.

① Baste batting and fabric together and them stitch quilting.

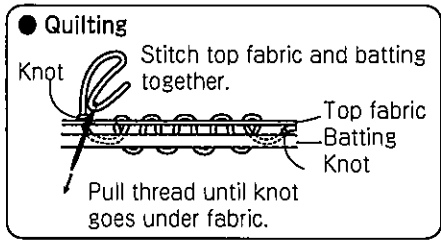
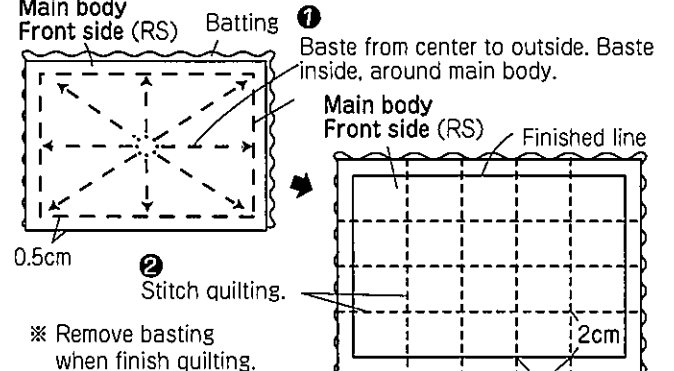

② Attach key rings to ① with hammer.

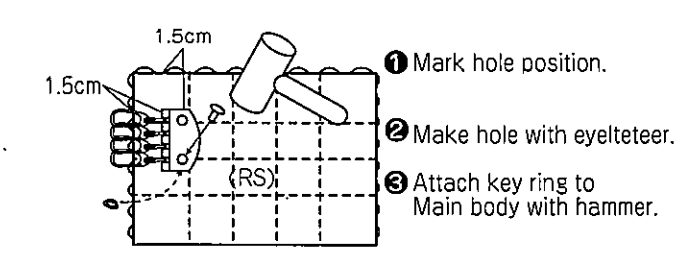

③ Attach flap at ② tentatively. ※ Attach it at 2 places.

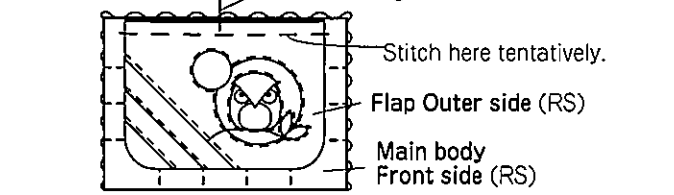

④ Put right side of ③ and Main Body Back side (3-④) together to make Outer bag.

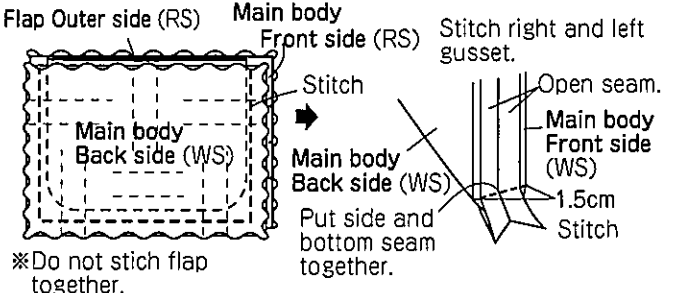

5 Make Inner bag.

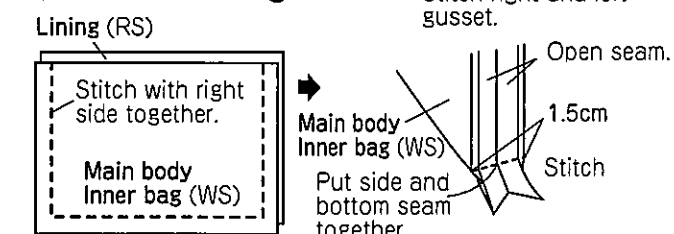

6 Put wrong side of Inner and Outer bag together, stitch both top seam tentatively.

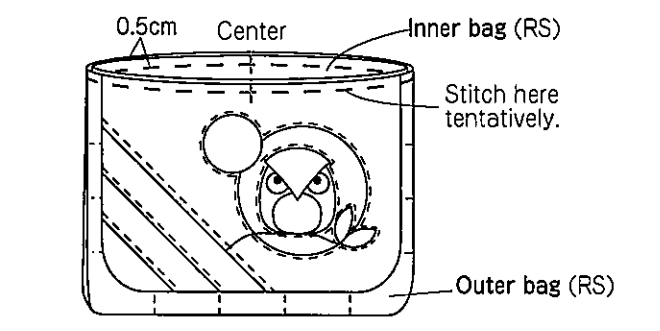

7 Attach piping to top seam.

※Use pins to fix fabric before stitching.

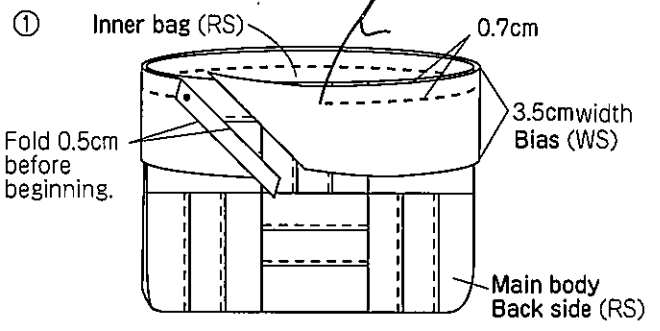

② Overlap 0.5cm at ending and cut away extra.

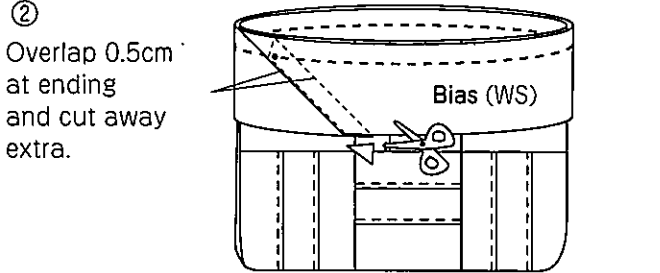

③ Turn lining outside.

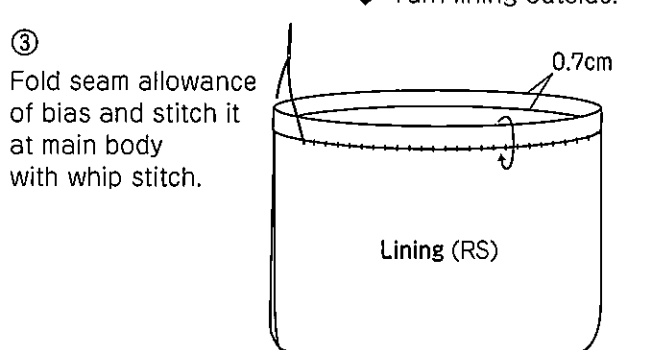

How to attach piping

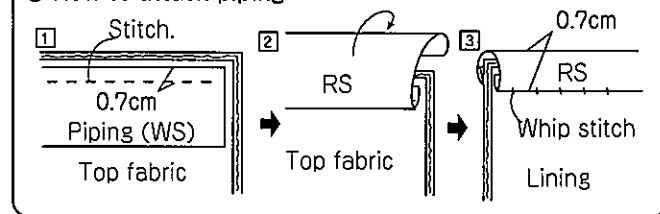

8 Attach zipper.

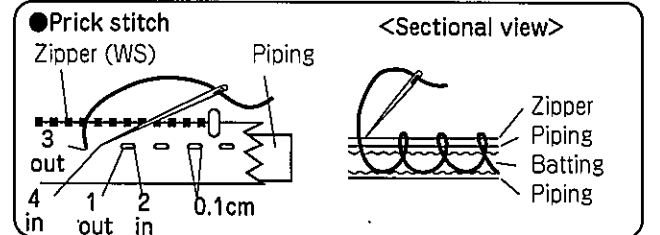
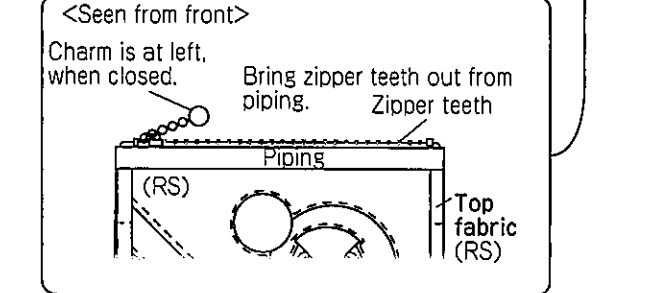
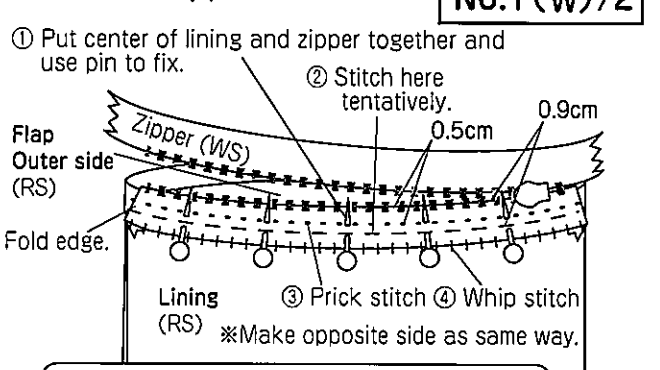

9 Attach snap buttons.

